

A nighttime photograph of the Royal Victoria Regional Health Centre (RVH) building. The building features a prominent glass facade and a large, illuminated entrance canopy. The text "PGMEAC - SITE UPDATE" is overlaid in large, white, bold letters at the top. Below it, the text "ROYAL VICTORIA REGIONAL HEALTH CENTRE (RVH)" is also overlaid in large, white, bold letters. In the foreground, a sign for the RVH is visible, displaying the logo and the name in both English and French.

PGMEAC - SITE UPDATE

**ROYAL VICTORIA REGIONAL HEALTH
CENTRE (RVH)**

RVH

Royal Victoria
Regional
Health Centre

Centre régional
de santé
Royal Victoria

Medical Education at RVH



Long Term Connections with Learners



Exception Learning Environment



Community Recruitment

Medical Education at RVH

- Anesthesia
- Cardiology
- Critical care
- Diagnostic Radiology
- Emergency
- ENT
- Family Medicine
- Gastroenterology
- General Surgery
- Gyne Onc
- Internal Medicine
- Medical Oncology
- Medicine
- Nephrology
- OBGYN
- Pediatrics
- Plastic Surgery
- Psychiatry
- Radiation Oncology
- Rheumatology
- Urology

Medical Education at RVH

- **Continuous improvements of the learning environment**
 - We are constantly looking for opportunities to improve our learner experience
- **Streamlined onboarding processes**
 - Leveraging automation through redcap, learners complete their onboarding up to 21 days before arriving on site to maximize the amount of time they can spend in clinic on their first day
- **Individualized experiences for medical learners**
 - Each learner is met in person on their first day, provided with their badge, taken to the parking office and provided a tour of the facilities prior to attending computer training
- **Support throughout a learner's rotation**
 - Learners are provided with the contact information of the medical education office and they are encouraged to reach out with any questions via cell phone or email

Medical Education at RVH

- Physicians lounge with touchdown spots
- Surgery lounge
- 24/7 gym access
- Discounted parking
- Wi-Fi access
- 24/7 food court and local restaurants
- Multiple On-site call rooms
- Simulation center (manikin and Virtual reality)

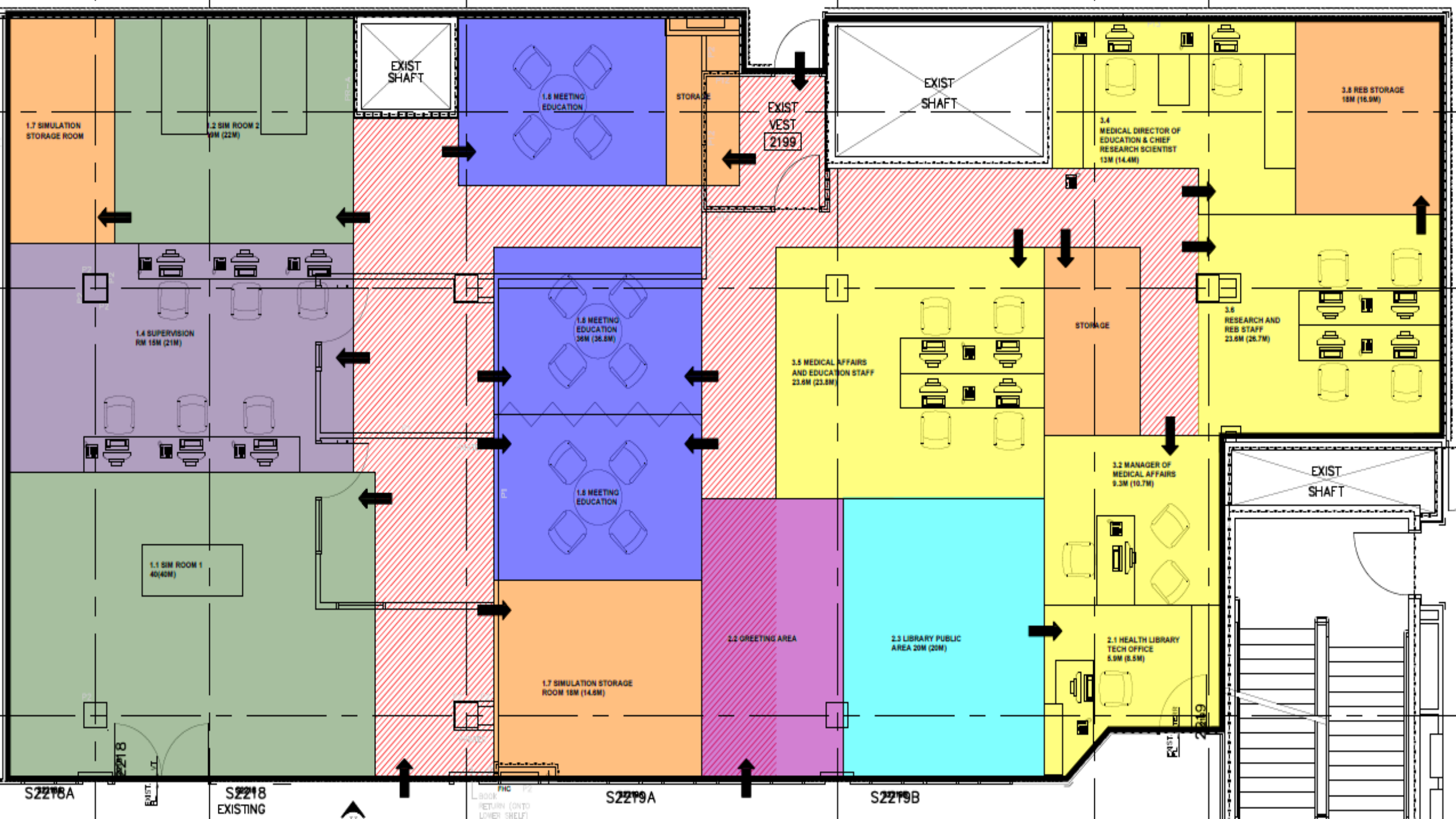

Medical Education at RVH

- Online registration via REDCap
- Meditech expense training and access
- ARIA access (Oncology rotations)
- Account access (same setup as staff)
 - Email access valid during rotation
 - Microsoft services access (outlook, teams, SharePoint)
- ID Badges
- Scrub access (specific departments)
- Discounted parking
 - UGY - \$6.50
 - PGY - \$13.13

Medical Education at RVH

- Office Hours: Monday to Friday, 0800 – 1600
 - 201 Georgian Drive, Barrie, ON
 - Health Library, 2nd Floor
- Virtual: Available via email or by phone at any time
 - MedicalEducation@rvh.on.ca
- Confidential communication:
 - Andrew Broeren – broerena@rvh.on.ca
 - Mitch Greene – greenem@rvh.on.ca